

---

# University of Missouri

Ellis Library Programming and Conceptual  
Design Kick-Off Meeting

April 4, 2019

**SHEPLEY  
BULFINCH**

# Agenda

## Staff Advisory Group

- Schedule
- Current Trends – What's Next?
- Report out on Benchmarking
- Challenges and opportunities
- Discussion



# Trends and Drivers

# The academic library of 2020

**Library**



**Gen X**

**Gen Y (Millennials)**

**Gen Z**



# The academic library of 2020

**Library**



**Learning commons**



**Gen X**

**Gen Y (Millennials)**

**Gen Z**



# The academic library of 2020

Library



Learning commons

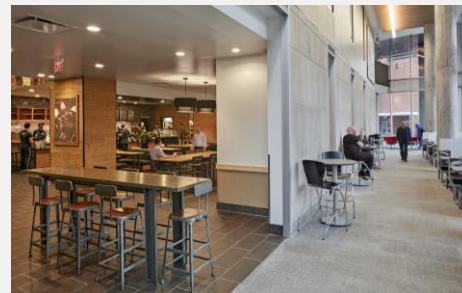

Workshop



Gen X

Gen Y (Millennials)

Gen Z







# Versatility, Commons

The Edge | Duke University



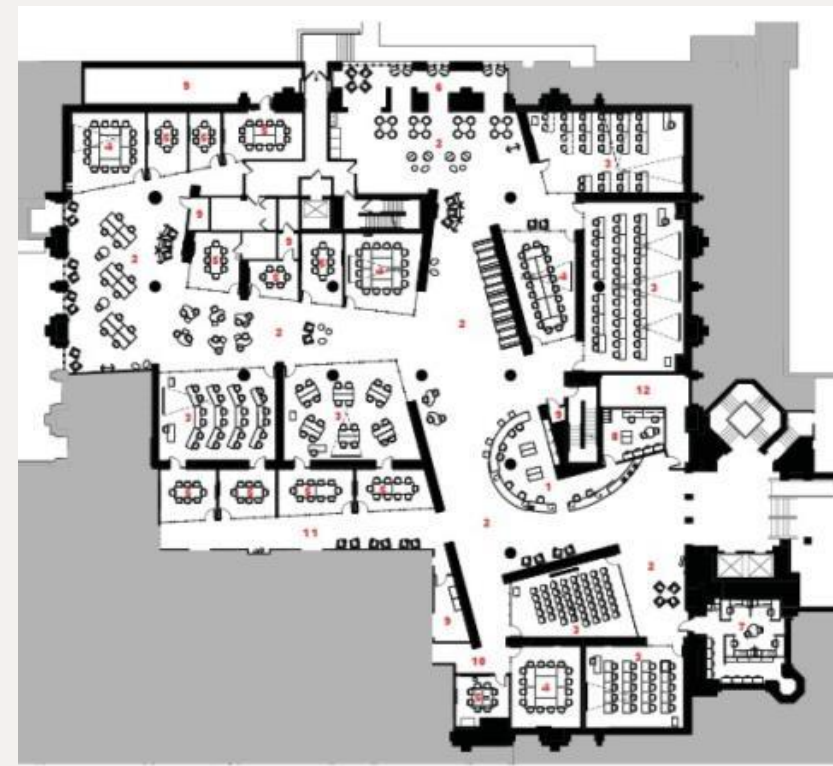

## Convertible Space

Duke University | The Link, Perkins Library



1 PM



Classroom



Seminar Room



Group Study

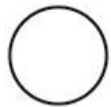

Open Work Space



1 AM



Classroom



Seminar Room



Group Study

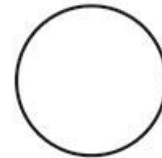

Open Work Space

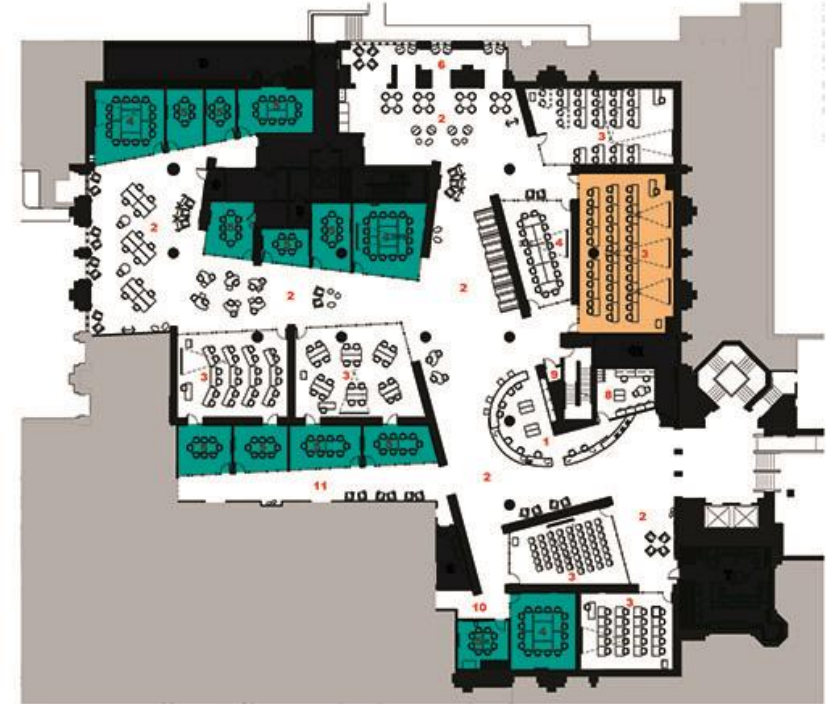

## Teaching and Learning Spaces - Convertible Space

Duke University | The Link, Perkins Library





# Experimentation and Evolution

Teachers College at Columbia University | The Learning Theater





Idea Incubation | Entrepreneurship





# Knowledge and Content Creation

The Workshop, Cabell Library | Virginia Commonwealth University





## Visualization

North Carolina State University | Hunt Library

University of Calgary | Taylor Family Digital Library





Research Reading Rooms





## Showcase Research





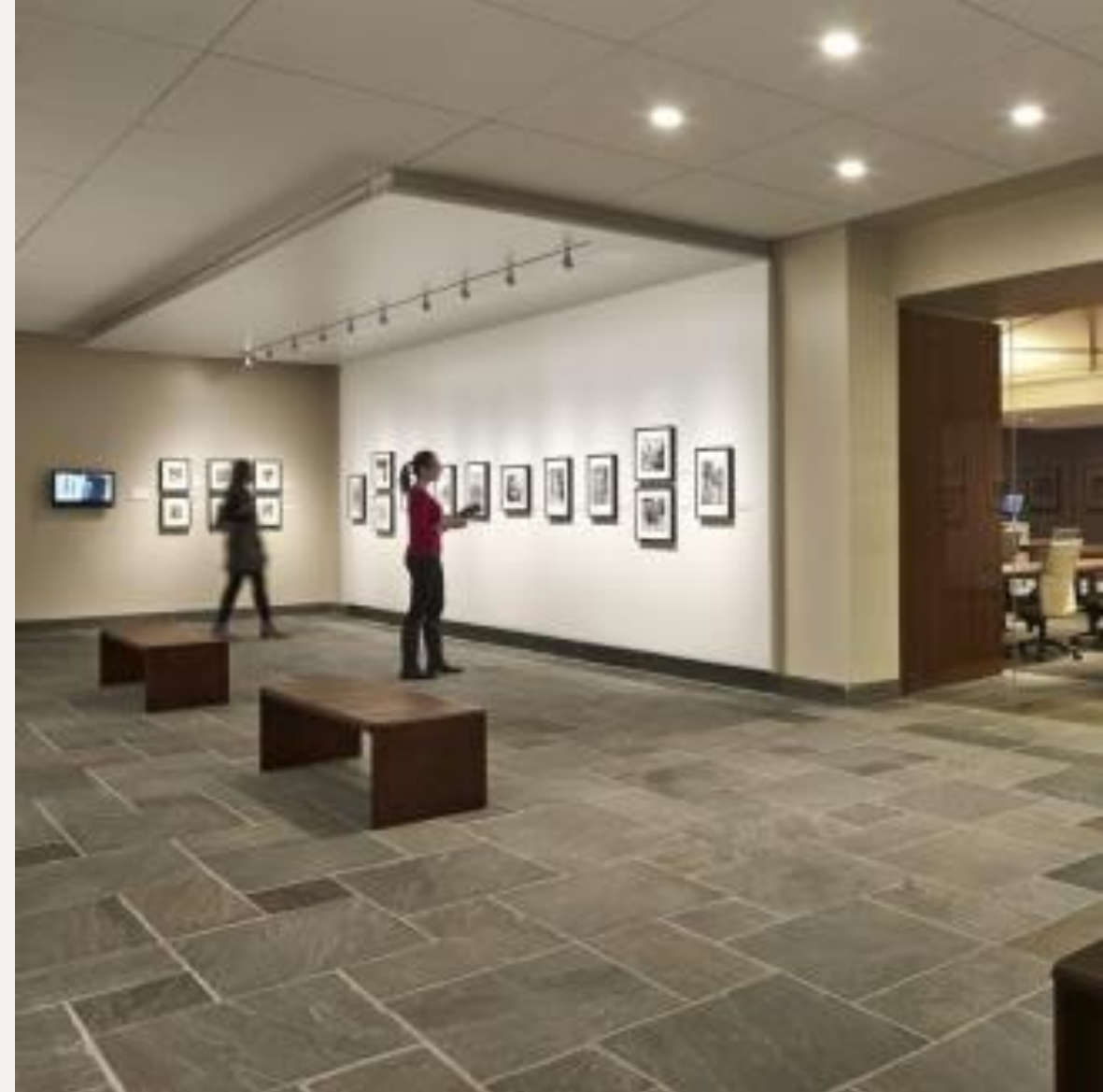

Culture portal / Heritage collection





Outdoor Spaces





Event / Meeting Space





Service Models - Concierge



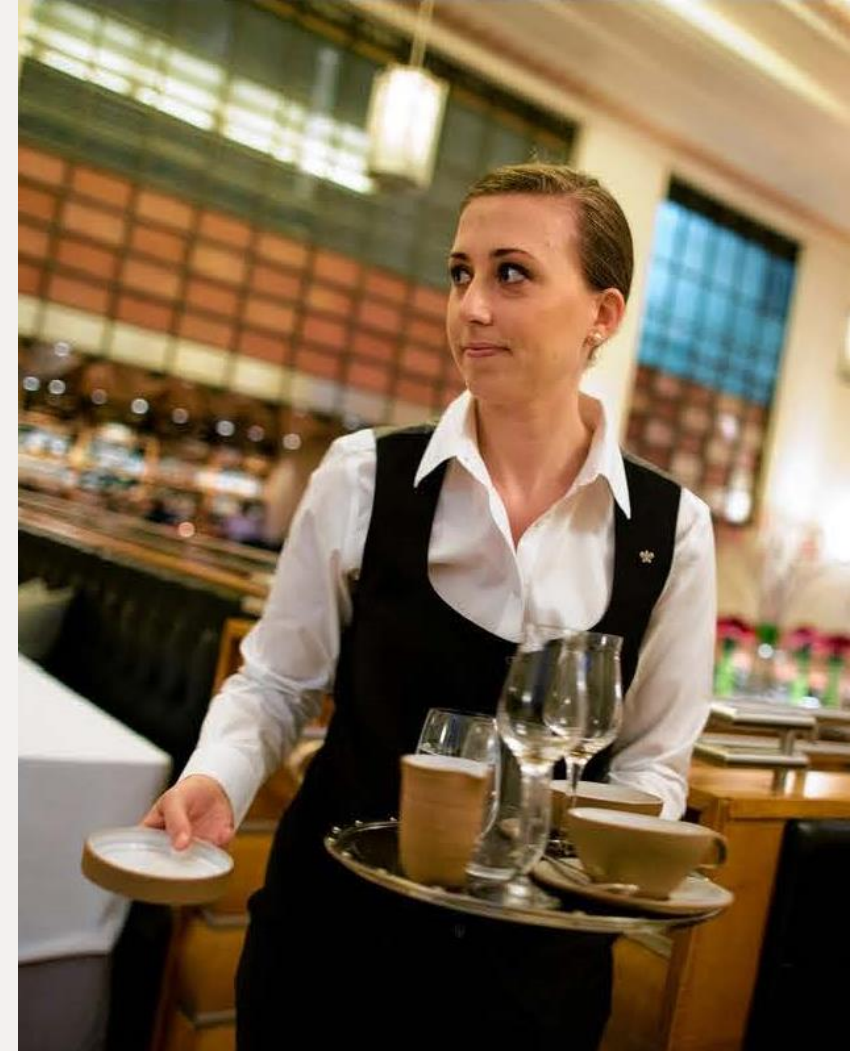

Service Models – Self Serve



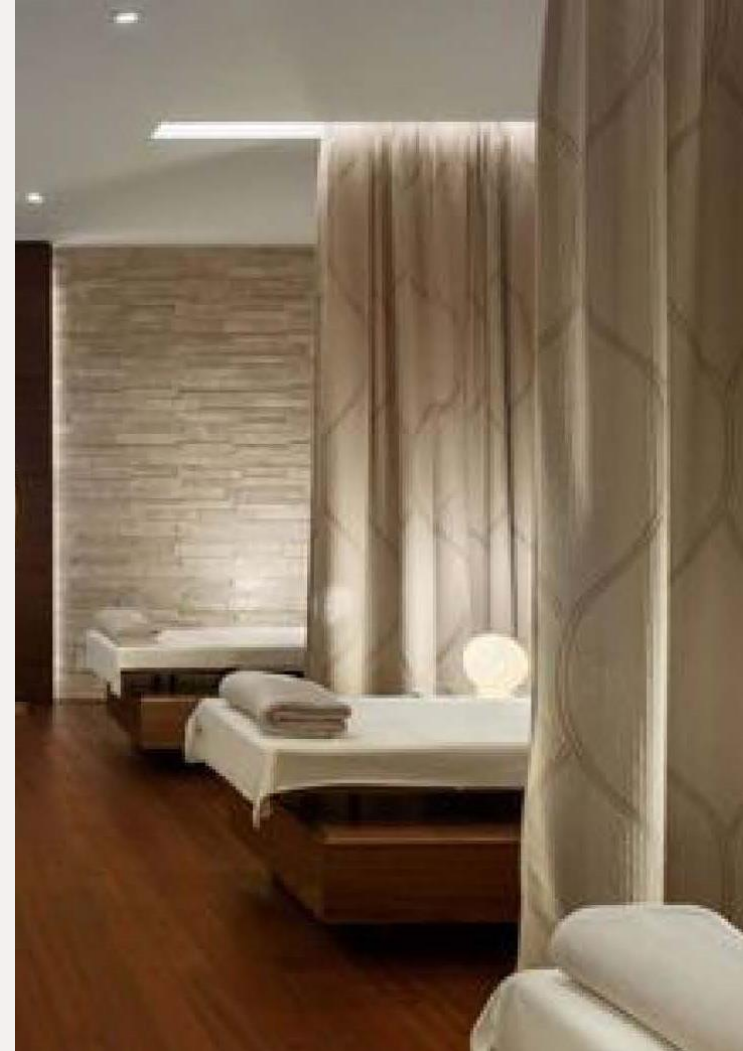

Service Models - Curated



## Staff Space – Collaboration and co-working





Services: Pop-Up vs. Home Base





# Transformation

Woodruff Library | Atlanta University





# Transformation

Hesburgh Libraries | University of Notre Dame





# Transformation

The Edge | Duke University





# Transformation

Firestone Library | Princeton University



# Library Evolution

## Space Allocation Models

Mid-20th Century

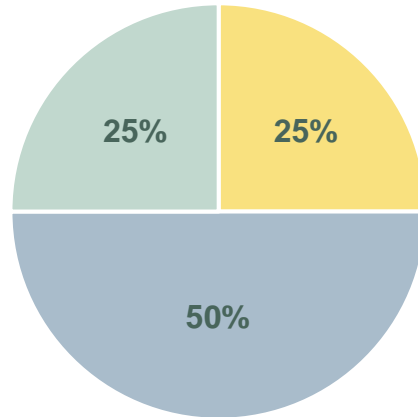

Contemporary/21st Century

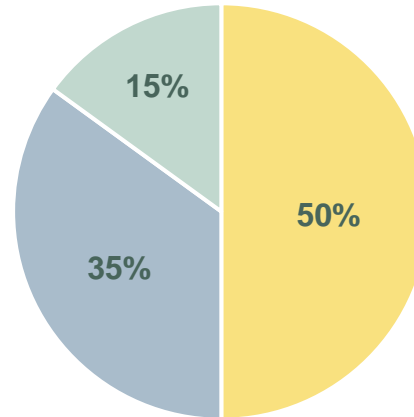

Progressive/21<sup>st</sup> Century

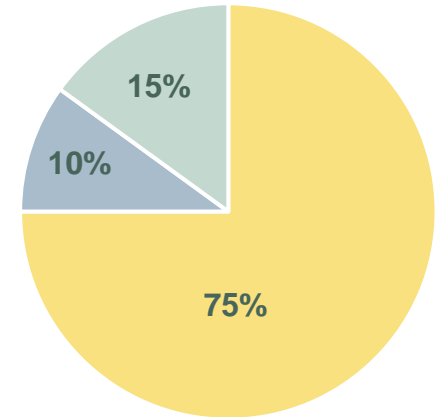

● Patron Space

● Staff/Services

● Collections



# Library Evolution

## Space Allocation Models

### Existing Ellis Library

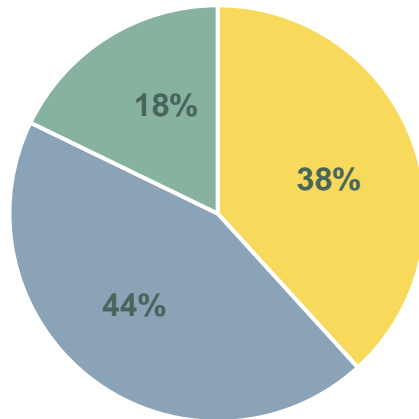

● Patron Space

● Staff/Services

● Collections



# Library Evolution

## Space Allocation Models

Existing Ellis Library

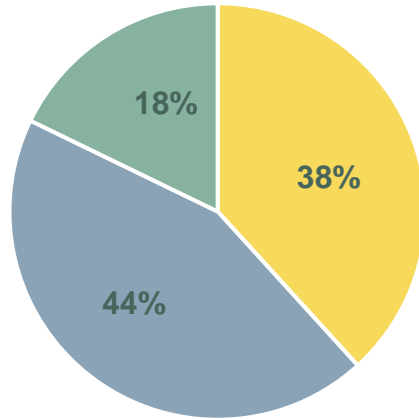

Contemporary/21st Century

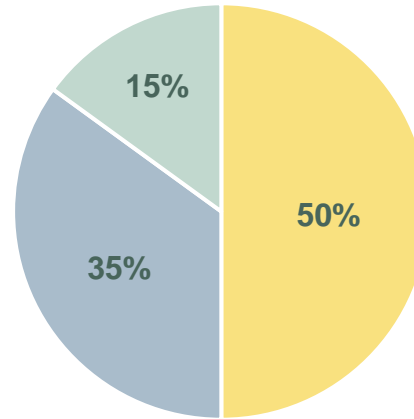

Progressive/21<sup>st</sup> Century

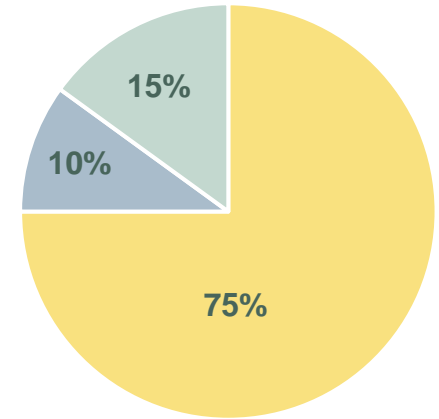

● Patron Space

● Staff/Services

● Collections



# Library Seating

How does Mizzou compare?

University Library	Student Enrollment	% Seats per Student
UVA Alderman	~23,900	16%
University of Michigan	~43,400	16%
Stony Brook	~21,277	13%
Harvard University	~28,100	24%
Rice University	~4,000	30%
Wisconsin	~41,500	19%
University of Minnesota	~39,303	10%
University of Alabama	~32,488	15%

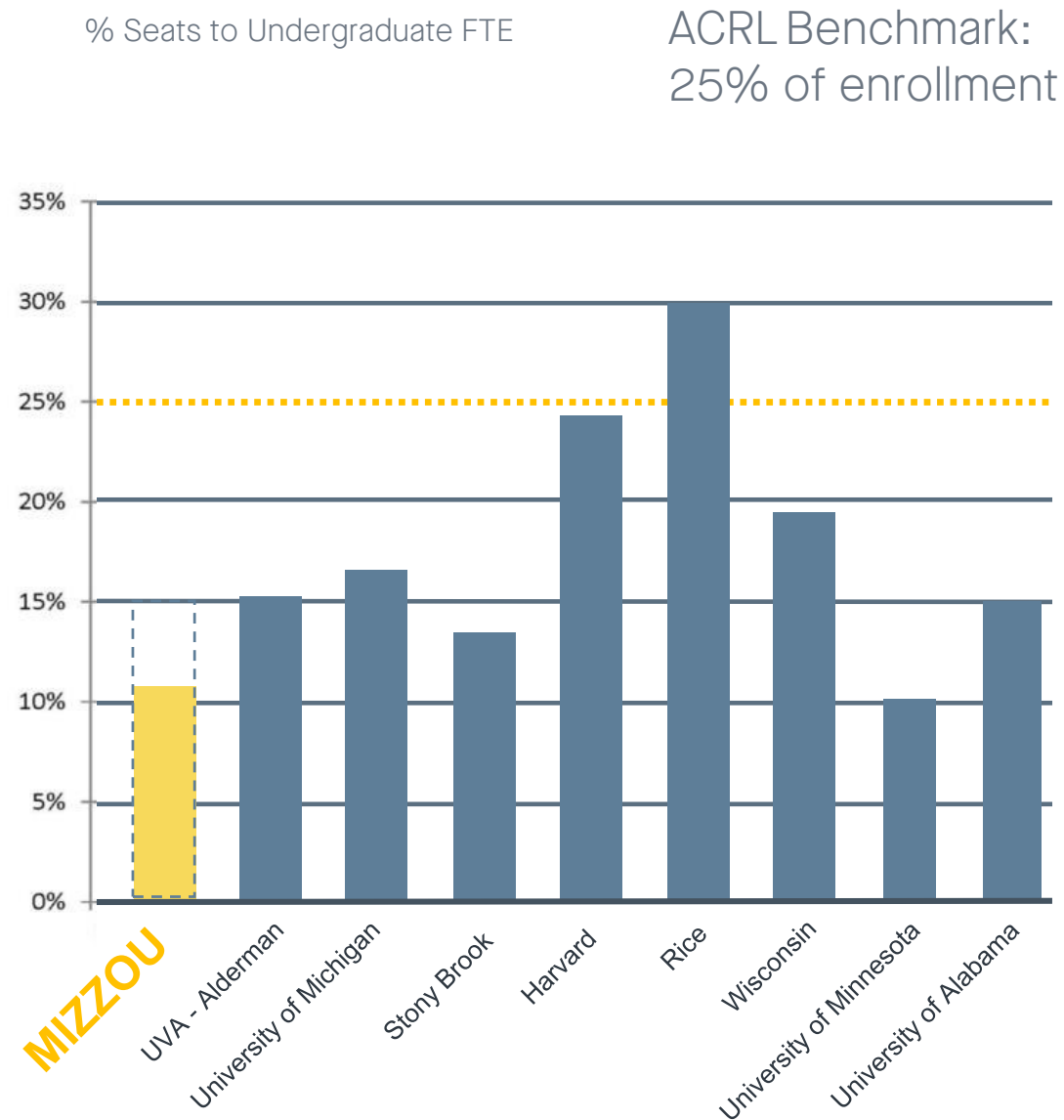

- What programs and spaces should the library provide for faculty and students to advance current, emerging and future research and learning?
- What programs on campus are natural partners for the library?
- What does Ellis do well now? What is missing or could be improved?
- Moving forward, how will scholars interact with information, content and data?
- With Ellis as a central hub on campus, what does this say about the types of programs and resources it should provide?



Next Steps