

Space Planning & Feasibility Study

University Libraries

February 5, 2021

Deb Ward, Interim Vice Provost for Libraries / Interim University Librarian



Components of Libraries' Space Planning

- Health Sciences Library Space Reduction Planning with School of Medicine
- Shepley-Bulfinch Ellis Library Master Plan (visioning), December 2019
- ULSAC Student visioning plan, 2018 updated in 2020
- PGAV Feasibility Study, January 2020
- PGAV Refined Master Plan (based on feasibility study), still ahead

Shepley Bulfinch Study



Feasibility Study



Identify best location for the co-location of University Archives, Special Collections, and Digital Services, providing increased visibility, more functional work spaces, and a better preservation environment for the collections



Identify best location for central, unified service desk, providing improved sight lines for users and greater flexibility for the future



Cost out project estimates and identify first project for implementation



Libraries

University of Missouri

ELLIS LIBRARY

FEASIBILITY STUDY FOR SPACE CONSOLIDATION

DRAFT FINAL REPORT

CP202401 | December 18, 2020

PGAVARCHITECTS



Libraries

University of Missouri

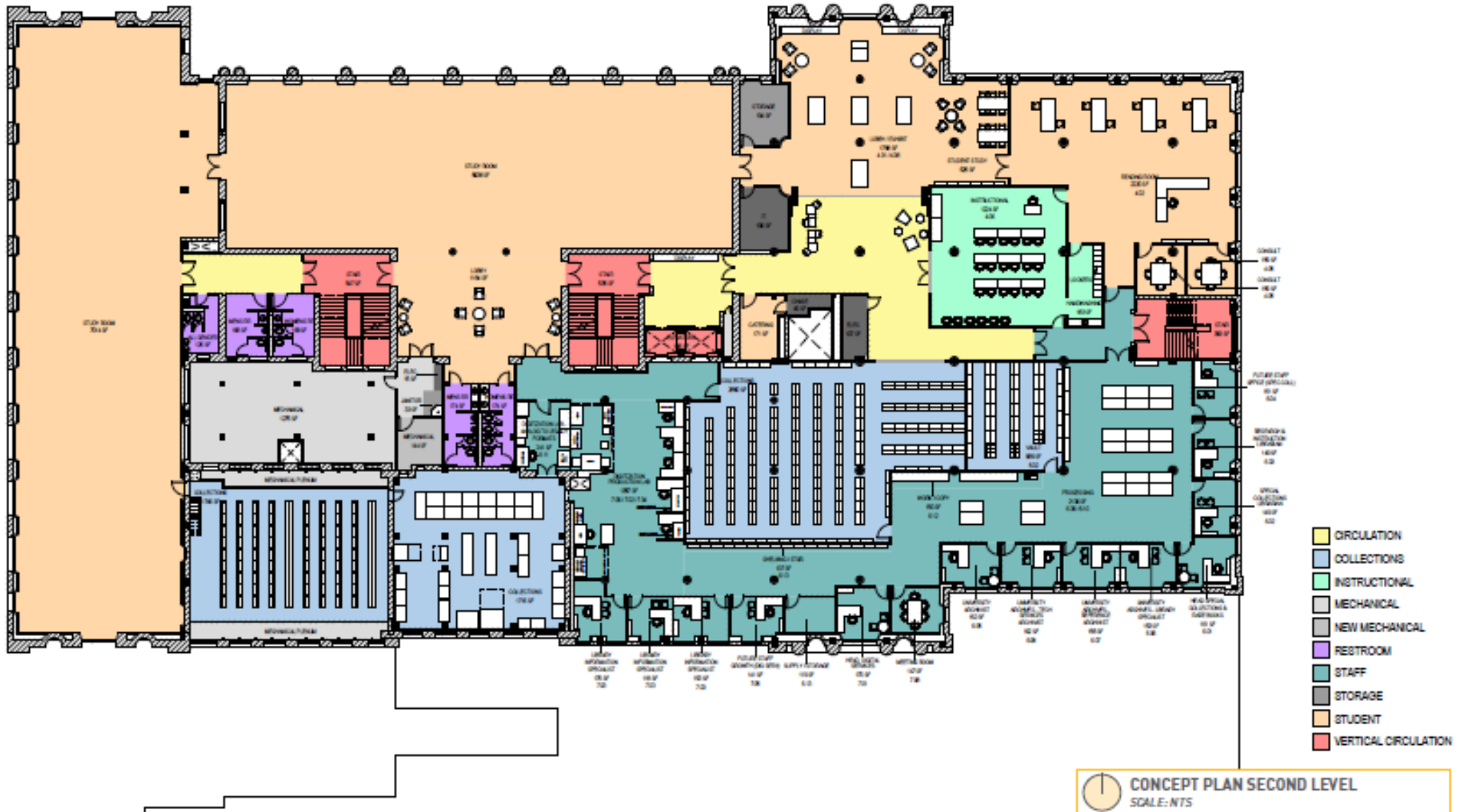

Obstacles to Archives Move

- West stacks renovation requires complete emptying of the contents prior to refurbishment. There are ~150,000 volumes in the lower levels that we want to renovate for this purpose.
- West stacks structure consists of approximately two stack levels per floor. Removal of materials on the half-floors must be done by dumb waiter, slowing removal of books from those spaces.
- Some materials in west stacks are the very books that patrons want most to browse rather than merely retrieve for content. Sorting and relocating them requires time.
- Cost of renovation of entire stack area is close to \$1M, a cost that does not include removal of materials.

Obstacles to Archives Move, cont.

- Heavy microforms cabinets in current Special Collections and other areas must be moved to other locations in order to move Archives personnel and materials into those spaces.
- Time to remove materials, followed by renovation does not fit into the timeline for moving Archives into Ellis Library.
- The steam tunnel project for Hitt Street planned for early summer will close access to the Ellis Library loading dock temporarily, during the time we might need it for moving items.

Decisions, January 2021

Delay renovation of West Stacks

Find alternative location for Archives for the short-term

Repurpose space in Special Collections to accommodate Archivists

Continue to work towards long-term goals for the consolidated departments:
Special Collections, University Archives, Digital Services



[SEE NEXT PAGE FOR ENLARGED PLAN]

SERVICE DESK - KEY PLAN
SCALE: NTS



Next step in planning: Updated Master Plan



Strategies Under Consideration

- Use rooms 85, 86, and 88 for swing space as we move collections around.
- Relocate compact shelving in HSL first floor to Ellis Room 88 in order to increase volume capacity
- Increase temporary reassignments of service desk personnel short-term to assist with book transfers to UMLD, so long as it does not interfere with hours of operation of the libraries.
- Consider relocating ILL staff to UMLD, when feasible.

Strategies, cont.

- Invest in electronic back-files of journal titles to reduce space requirements and physical management of print journal runs, while still ensuring access in perpetuity.
- Invest in electronic back-files of historical newspapers currently on microforms to reduce space requirements and address issues related to the deterioration and sheer weight of the physical items and their cabinets.
- Use touch-down spaces instead of offices for personnel who work part-time from home.

Evaluating Library Use, FY19

- Total visits 1,211,477 People
- Circulation 67,645 Check-outs
- F2F Instruction 13,262 Participants
- On-site Reference 7,427 Questions
- Virtual Reference 7,809 Questions

Questions

- What advantages do you see to the location of the unified service desk in the central location on First Floor?
- As we plan to bring University Archives into Ellis Library, due to the timing, we are planning to blend it with the Special Collections spaces on Fourth Floor. What are your thoughts about relocating both units to the Second Floor, when we can raise the needed funds?
- As we think about how student and faculty use of libraries may change over the next decade, what elements may fade? What new elements may emerge?



Thanks for participating today!